

Group:	AC203RA Series	Notes: AC203RA series alternators
Form:	SP4008-US	
Date:	September 16, 2010	
File:	Alternator Parts List Section	

AC203RA SERIES ALTERNATORS

PART NO:	ROTOR ASSY [1] QTY 1	STATOR ASSY [2] QTY 1	DRIVE END HOUSING [3] QTY 1	REAR END HOUSING [4] QTY 1	KEY [9] QTY 1	FAN [10] QTY 1	BEARING KIT SEE NOTES 2A & 2B	DRIVE END BEARING [12] QTY 1	REAR END BEARING [13] QTY 1
1286000	6332-A1388	6332-A1469	6270-511	6270-508	NK1-9	6360-254	6270-571A	6500-173	6360-252
1286010	6332-A1388	6332-A1471	6270-511	6270-508	NK1-9	6360-254	6270-571A	6500-173	6360-252
1286500	6332-A1388	6332-A1470	6270-511	6270-508	NK1-9	6360-254	6270-571A	6500-173	6360-252
1286510	6332-A1388	6332-A1472	6270-511	6270-508	NK1-9	6360-254	6270-571A	6500-173	6360-252
1286560	6332-A1388	6332-A1480	6270-511	6270-508	NK1-9	6360-254	6270-571A	6500-173	6360-252
1286570	6332-A1388	6332-A1479	6270-511	6270-508	NK1-9	6360-254	6270-571H	6506-109	6360-252
1286580	6332-A1492	6332-A1479	6270-586A	6270-591	NK1-9	6270-588	6270-571J	6360-251	6360-252
1286590	6332-A1494	6332-A1479	6270-598	6270-591	NK1-9	6360-254	6270-571J	6360-251	6360-252
1286600	6332-A1388	6332-A1479	6270-598	6270-591	NK1-9	6360-254	6270-571J	6360-251	6360-252
1286620	6332-A1499	6332-A1502	6270-603	6270-605A	6360-201	6360-254	6270-571J	6360-251	6360-252
1286630	6332-A1388	6332-A1470	6270-511	6270-508	NK1-9	6360-254	6270-571H	6506-109	6360-252
1286640	6332-A1494A	6332-A1479	6270-598	6270-591	NK1-9	6360-254	6270-571J	6360-251	6360-252
1286660	6332-A1494A	6332-A1504	6270-598	6270-626	NK1-9	6360-254	6270-571J	6360-251	6360-252
1286670	6332-A1492	6332-A1505	6270-586A	6270-591	NK1-9	6270-588	6270-571J	6360-251	6360-252
1286680	6332-A1494A	6332-A1480	6270-598	6270-591	NK1-9	6360-254	6270-571J	6360-251	6360-252

PART NO:	SLIP RING [16] QTY 1	STAUFFER LUBRICATOR [17] QTY 1	RECTIFIER PACK [19] SEE NOTE: 1	LEAD ASSY +VE [21] QTY 1	LEAD ASSY -VE [22] QTY 1	DIODE KIT [23] 3 REQD	REGULA- TOR [41] QTY 1	BRUSH BOX HOUSING [42] QTY 1	BRUSH KIT SEE NOTE 2E [QTY 1]
1286000	6019-464	5886-242	6270-523	6270-528	6270-528A	6010-238	1861A726	6270-506	6270-571D
1286010	6019-464	5886-242	6270-523	6270-528	6270-528A	6010-238	1861A726	6270-506	6270-571D
1286500	6019-464	5886-242	6270-524	6270-527	6270-527A	6010-239	1861A726	6270-506	6270-571D
1286510	6019-464	5886-242	6270-524	6270-527	6270-527A	6010-239	1861A726	6270-506	6270-571D
1286560	6019-464	5886-242	6270-524	6270-527	6270-527A	6010-239	1861A726	6270-506	6270-571D
1286570	6019-464	5886-242	6270-524	6270-527	6270-527A	6010-239	1861A726	6270-506	6270-571D
1286580	6360-431	-	6270-524	6270-527	6270-527A	6010-239	1861A726	6270-592	6270-571D
1286590	6360-431	-	6270-524	6270-527	6270-527A	6010-239	1861A726	6270-592	6270-571D
1286600	6019-464	-	6270-524	6270-527	6270-527A	6010-239	1861A726	6270-601	6270-571D
1286620	6360-431	-	6270-524	6270-527	6270-527A	6010-239	1861A742	6270-592	6270-571D
1286630	6019-464	5886-242	6270-524	6270-527	6270-527A	6010-239	1861A726	6270-506	6270-571D
1286640	6360-431	-	6270-524	6270-527	6270-527A	6010-239	1861A726	6270-592	6270-571D
1286660	6360-431	-	6270-524	6270-527	6270-527A	6010-239	1861A742	6270-592	6270-571D
1286670	6019-464	-	6270-524	6270-527	6270-527A	6010-239	1861A726	6270-592	6270-571D
1286680	6360-431	-	6270-524	6270-527	6270-527A	6010-239	1861A726	6270-592	6270-571D

Important: The information contained in this bulletin is intended for use by trained, professional technicians who have the proper tools, equipment, and training to perform the required maintenance described above. This information is NOT intended for 'do-it-yourselfers', and you should not assume that this information applies to your equipment. If you have any questions regarding this information please visit our website at www.prestolite.com, or contact our technical service department at:

Group:	AC203RA Series	Notes: AC203RA series alternators
Form:	SP4008	
Date:	September 16, 2010	
File:	Alternator Parts List Section	

COMMON PARTS							
ITEM NO:	PART NO:	QTY	DESCRIPTION	ITEM NO:	PART NO:	QTY	DESCRIPTION
5	6270-326	1	BRG. CLAMP PLATE	43	6270-495	1	BRUSH BOX ASSY
6	6270-499	3	HEATSINK	44	NS206-11Z1	2	SCREW
7	5330-501	1	NUT	45	5293-39	2	SPRING WASHER
8	6270-487	1	BELLEVILLE WASHER	46	NW2-13Z1	2	WASHER
11	6270-180C	1	D.E. OIL SEAL	47	6270-491	1	BRUSH BOX CONTAINER
14	5886-200C	1	ROTOR CIRCLIP	48	6220-600	1	GASKET
15	5950-381	1	BRG. RET. CIRCLIP	50	6270-503	1	TERMINAL COVER
18	6270-517	1	TERMINAL ASSY	51	6270-530	1	LEAD ASSY
20	6220-922	1	SUPP. & LEAD ASSY	52	6506-61	1	DEUTSCH CONNECTOR
24	6270-529	1	YELLOW LEAD ASSY	53	5936-495D	4	WASHER
25	6002-501N	2	DIODE LINK [YELLOW]	54	NP1-2	4	SPRING WASHER
26	6220-141	6	INSULATION WASHER	55	NS200-10Z1	4	SCREW
27	6270-534	1	SPACER	56	6270-533	1	DEUTSCH SEAL PLUG
28	6350-105AJ	1	BRUSH BOX "O" RING	57	5459-716	1	LUCAR BLADE
29	5335-963G	4	SKT.HD.CAPSCREW	58	6270-538	1	FLEXIBLE PLUG
30	5335-972C	2	SKT.HD.CAPSCREW	59	6270-515	1	POSITIVE TERMINAL
31	5293-57	35	SPRING WASHER	60	5335-971H	1	NEGATIVE TERMINAL
32	5335-963C	11	SKT.HD.CAPSCREW	61	5936-495M	1	WASHER
33	6270-532	4	BELLEVILLE WASHER	62	6506-32A	1	INSULATOR
34	5936-502	4	PLAIN WASHER	63	5936-495N	1	WASHER
35	6500-22	2	INSULATION BUSH	64	5001-43	2	SPRING WASHER
36	6500-22A	2	INSULATION BUSH	65	NU11-10T1	2	NUT
37	5335-963E	18	SKT.HD.CAPSCREW	66	NU11-9T1	1	NUT
38	6270-541	1	ASSEMBLED COVER	67	6270-514	1	INSULATOR
39	6270-501	1	ELBOW (not 1286620)	68	NU11-7T1	2	NUT
	6270-619	1	AIR INLET ADAPTOR	69	5001-26	2	SPRING WASHER
	6270-623	1	HOSE CLAMP (1286620 only)	70	6220-75	1	GASKET
40	6270-504	1	SELF TAP SCREW	71	5855-30EX	1	" O " RING

NOTE: 1 - RECTIFIER PACK [19] IS A COMPLETE ASSEMBLY, INCLUSIVE OF LEADS, WITH ASSEMBLED HEATSINKS AND DIODES. - SEE NOTE 2M

NOTE 2 - THE FOLLOWING KITS ARE ALSO AVAILABLE. QUANTITIES OF FIXINGS AND FASTENINGS WILL VARY FROM THOSE SHOWN, AND WILL DEPEND ON KIT REQUIREMENTS.

- A - BEARING KIT, PART NO: 6270-571A & 6270-571H, COMPRISES ITEMS 11, 12, 13, 14, 15, 27 & 28
- B - BEARING KIT, PART NO: 6270-571J, COMPRISES ITEMS 11, 12, 13, 14, 27, 28 & 71
- C - PULLEY RET: KIT, PART NO: 6270-571B, COMPRISES ITEMS 7, 8 & 9
- D - COVER & DUCT KIT, PART NO: 6010-234 COMPRISES ITEMS 38, 39 & 40
- E - BRUSH KIT, PART NO: 6270-571D COMPRISES ITEMS 43, 44, 45, 46, 47, 48 & 70
- F - SUNDRY PARTS KIT, PART NO: 6010-235 COMPRISES ITEMS 8, 11, 14, 28, 44 & 48
- G - FASTENER KIT, PART NO: 6270-571F COMPRISES ITEMS 8, 29, 30, 31, 32, 34 & 37
- H- DEUTSCH CONNECTOR KIT, PART NO: 6270-571G COMPRISES ITEMS 51, 52, 53, 54, 55 & 56 [LEAD ASSY ITEM 51 INCL]
- J - DEUTSCH CONNECTOR KIT, PART NO: 6010-236 COMPRISES ITEMS 52, 53, 54, 55 & 56 [LEAD ASSY ITEM 51 OMITTED]
- K - TERMINAL ASSY KIT, PART NO: 6270-571E COMPRISES ITEMS 18, 57, 58, 59, 60, 61, 62, 63, 64, 65, 66, 67, 68 & 69
- L - TERMINAL KIT, PART NO: 6010-237 COMPRISES ITEMS 59, 60, 61, 62, 63, 64, 65, 66, 67, 68 & 69 [ITEMS 18, 57 & 58 OMITTED]
- M - ASSEMBLED HEATSINKS COMPLETE WITH DIODES ARE ALSO AVAILABLE [3 REQD PER UNIT], PART NO: 6270-521 [FOR UNITS 1286000 & 1286510] AND PART NO: 6270-522 [FOR UNITS ALL OTHER UNITS] - NO LEADS ATTACHED. DIODE KITS ARE ALSO AVAILABLE - SEE ITEM 23 FOR RELEVANT PART NUMBER.

Important: The information contained in this bulletin is intended for use by trained, professional technicians who have the proper tools, equipment, and training to perform the required maintenance described above. This information is NOT intended for 'do-it-yourselfers', and you should not assume that this information applies to your equipment. If you have any questions regarding this information please visit our website at www.prestolite.com, or contact our technical service department at:

Group:	AC203RA Series	Notes:
Form:	SP4008-US	AC203RA series alternators
Date:	September 16, 2010	
File:	Alternator Parts List Section	

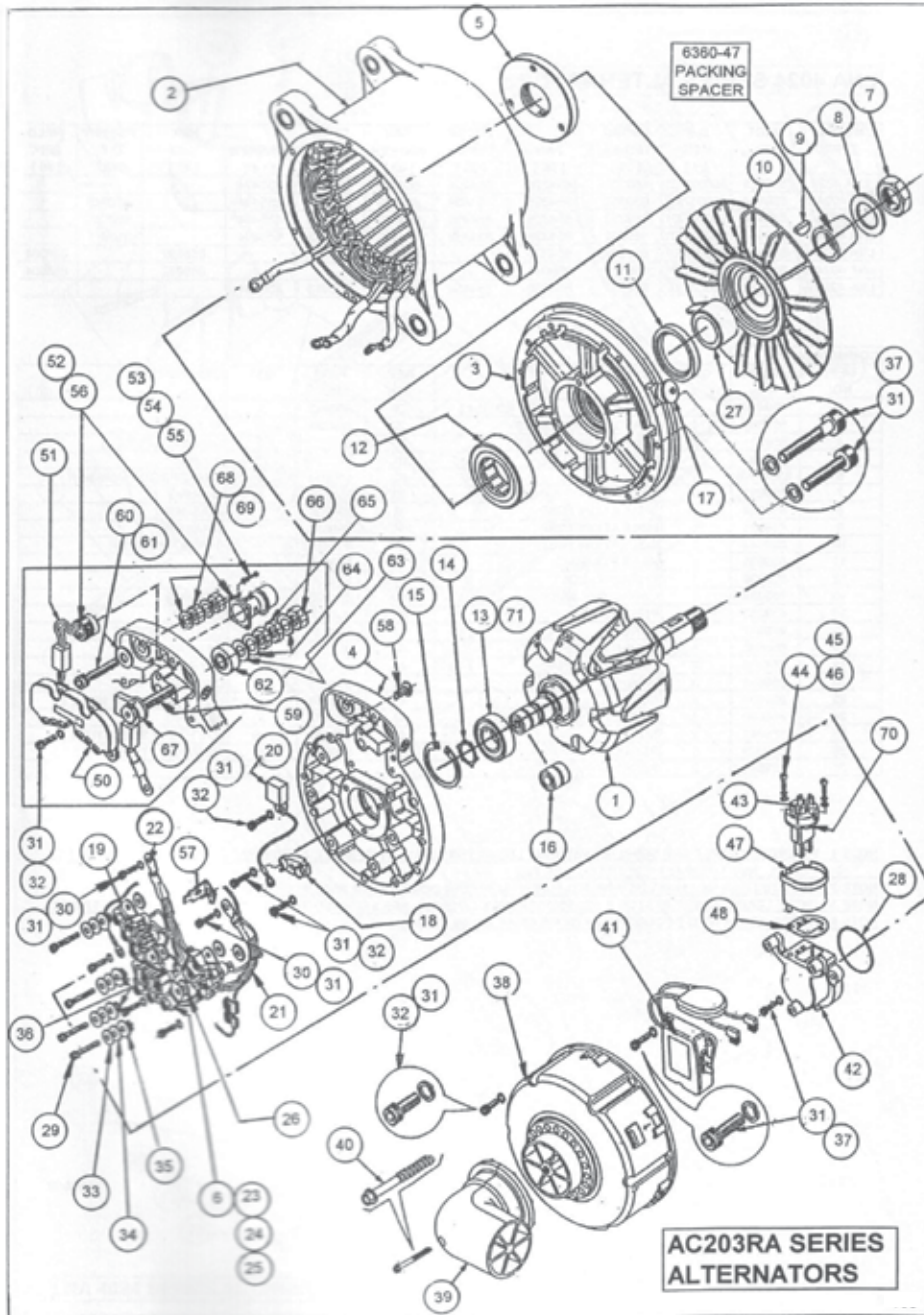

Important: The information contained in this bulletin is intended for use by trained, professional technicians who have the proper tools, equipment, and training to perform the required maintenance described above. This information is NOT intended for 'do-it-yourselfers', and you should not assume that this information applies to your equipment. If you have any questions regarding this information please visit our website at www.prestolite.com, or contact our technical service department at: