

Source: Leece-Neville Heavy Duty Systems Division - Arcade, NY USA
 Date: July 7, 2017
 Bulletin No: TSB-1063_A
 Models: M125R 12V Starters
 Subject: Wiring/ Terminal Identification

TSB will explain the wiring, terminal identifications and locations compared to a Leece Neville MS2 or Delco 42MT starters.

Image of M125 starter used in this document does not represent all models. Relay and ground terminal locations can be in slightly different locations.

Note: Each TITAN™ M125R starter is fitted with 3 paper terminal placards to help identify the terminals. These placards MUST be removed during installation. Failure to remove the placards may void the warranty.

It may be necessary to rotate the relay to another position to avoid a clearance issue on the vehicle. Loosen nut to reposition relay and tighten. Torque nut to 55-60 lbs-in.

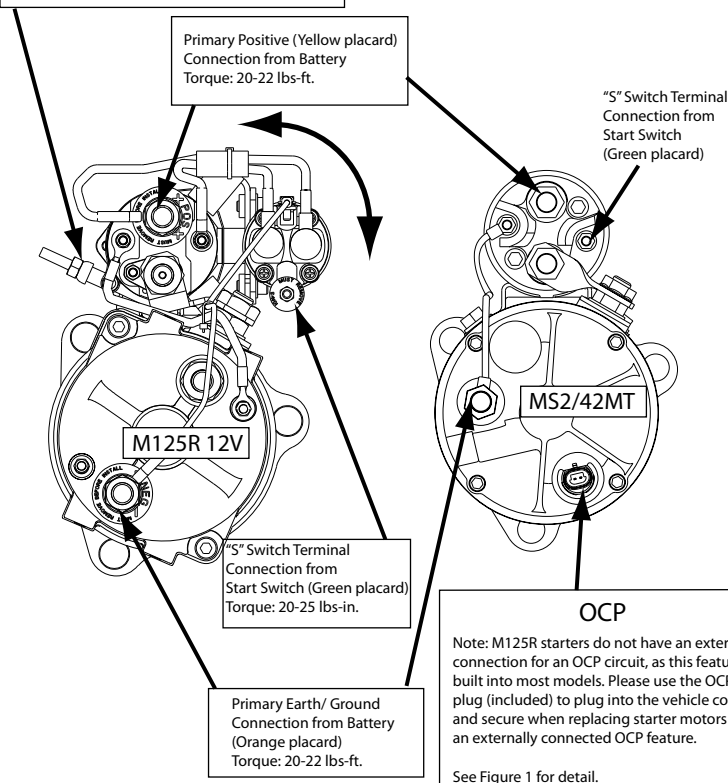

Note:
 IMS Relay is part of the starter soft start feature. This relay must not be removed under any circumstances as warranty will be void.
 Severe damage to the starter will be the result.

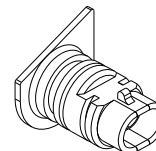

Fig 1
 M264105399S
 OCP Bypass Connector

To insure reliable long term operation it is critical that the vehicle ring gear be inspected for excessively worn or frayed edges of the ring gear teeth that may prevent engagement of the starter pinion. Replace ring gear if necessary.

Important: The information contained in this bulletin is intended for use by trained, professional technicians who have the proper tools, equipment, and training to perform the required maintenance described above. This information is NOT intended for 'do-it-yourselfers'; and you should not assume that this information applies to your equipment. If you have any questions regarding this information please visit our website at www.prestolite.com, or contact our technical service department at: